

Signage Add-on

The Signage Add-on enables Highways and streetworks teams to produce traffic management and signage plans in-house, driving cost savings through insourcing and better communication with TM companies.

This Add-on to the [Traffic Management App](#) offers a seamless and integrated process for streetworks planning and Traffic Management (TM) plan production. It often eliminates the need for complex CAD software or outsourcing the production of plans.

The web-based app replaces complicated TM plan design procedures with a simple, easy-to-use process, to prepare traffic management plans, detailing signage layouts for temporary traffic control for design review and setting out.

Full Chapter 8 signage layouts can be easily plotted, and with the familiar Google Maps interface combined with the detail and precision of OS MasterMap™, it makes the process of creating a traffic control plan a simple matter of dropping signage icons on the map.

How can Signage Add-on help?

Early adopters have reported substantial savings of up to 80% per plan by using this inexpensive cloud-based solution. It also offers

- Reduced time to create accurate signage plans
- Cost savings through insourcing and better communication with TM companies
- Simplified workflow using one common platform for creating TM and signage plans
- Instant visualisation to save planning time and cost prior to site visits

Functionality enables users to design detailed signing schedules and communicate works footprints.

It can be used for consultation, design review, setting out, annotation and for signing schedules (landscape and portrait).

A unique benefit is that the signage layout can be visualised by superimposing the signs on a Virtual Reality representation of the street scene using Google Streetview - giving an instant insight into the viability, safety and other factors prior to anyone visiting the site.

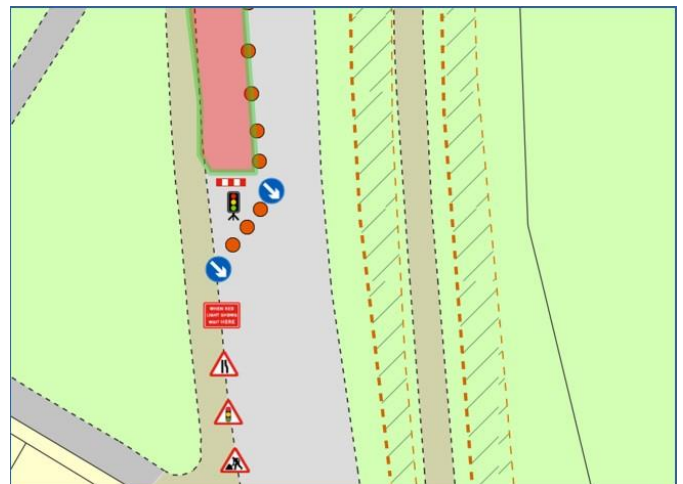

How does Signage Add-on work?

Users are expected to have a basic understanding of the Traffic Signs Manual, Chapter 8 to create traffic layouts that comply with the regulations, but require almost no training to use this simple tool, which demystifies the complex process of creating plans in traditional software.

- **Works Footprint** - identify the affected works area by drawing the area with a point, line or polygon.
- **Signage** - click and position the relevant signs for a road closure, diversion or other temporary traffic management interventions (TSRGD and links to Chapter 8 Traffic Signs Manual).
- **Help** - refer to the Red Book (Safety at Street Works Code of Practice).

Traffic management and signage plans can be completed in-house and when combined with [the Plan Share Add-on](#), can be electronically submitted to participating Highway Authorities seamlessly on a common platform.

This cuts out external costs, inefficient paper-based processes and the errors and fixed penalties that often arise from multiple hand-offs.

